



> **PERFECT SYSTEM**
SOLUTIONS IN CONCENTRATED

PERFECT ADVANTAGES



ECOLOGICAL

- Reducing packaging: improves the environmental impact
- Reducing CO2 emission of volumetric transport



HEALTH

- Minimal manipulation
- Products easily identifiable
- Minimizes labor risks: Load weight reduction up to 90%



ECONOMIC

- Reduction of almost 98% wood (cases and pallets)
- Reducing waste: bottles are reused and biodegradable packaging.

Equivalence ECO-DISbox

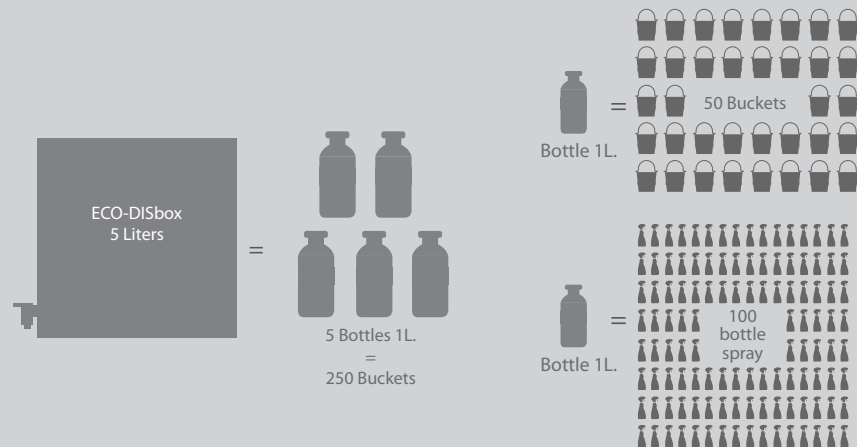

DISARP<SOLUTIONS IN CONCENTRATED

PERFECT OPERATION

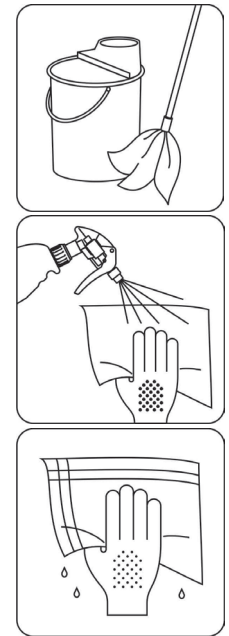

- * ECO-DISbox line is offered in 5 liters saving format.
- * No installation or maintenance required
- * Not using electrical system and does not use direct contact with water.
- * The operator never comes into contact with the product, thanks to the tap fitted to all ECO-DISbox.
- * Each product uses a line of color: Blue for indoor toilets and red for toilets and bathrooms.



Range H100 - Daily Detergent for toilets and bathrooms

Range H200 – Daily Detergent for indoor



ECO-DISBOX H100 PERFECT BAG IN BOX 5L

PT0487A500

Daily Detergent for toilets and bathrooms



ECO-DISBOX H200 PERFECT BAG IN BOX 5L

PT0488A500

Daily Detergent for indoor



H100 PERFECT 6X1L. BOX

PT0487A900

Daily Detergent for toilets and bathrooms



H200 PERFECT 6X1L BOX

PT0488A900

Daily Detergent for indoor



Consumable KIT H100 CE 6x500cc empty bottles

PT10240000

Daily Detergent for toilets and bathrooms



Consumable KIT H200 CE 6x500cc empty bottles

PT10250000

Daily Detergent for indoor